

Design of Floor System for Radon collection

The intent of the system is to use the combined lower groove areas of the supplied sections and the lower areas of the spacers and shims to provide: a fully connected grid that allows movement of soil gasses from any point within the grid to the extraction section location, eliminating the need for a below system layer of porous material or inset collection flow tube as would be required for traditional slabs. While the actual layouts may vary to accommodate site dimensions and conditions, all channels or areas of the system must have a clear and unblocked path thru the lower areas to the extraction section. A properly taped and sealed vapour barrier on top of the sections before sheeting then provides a complete collection system for soil gasses that is serviced for gas extraction by the application of negative pressure to the venting pipe located on the extraction section.

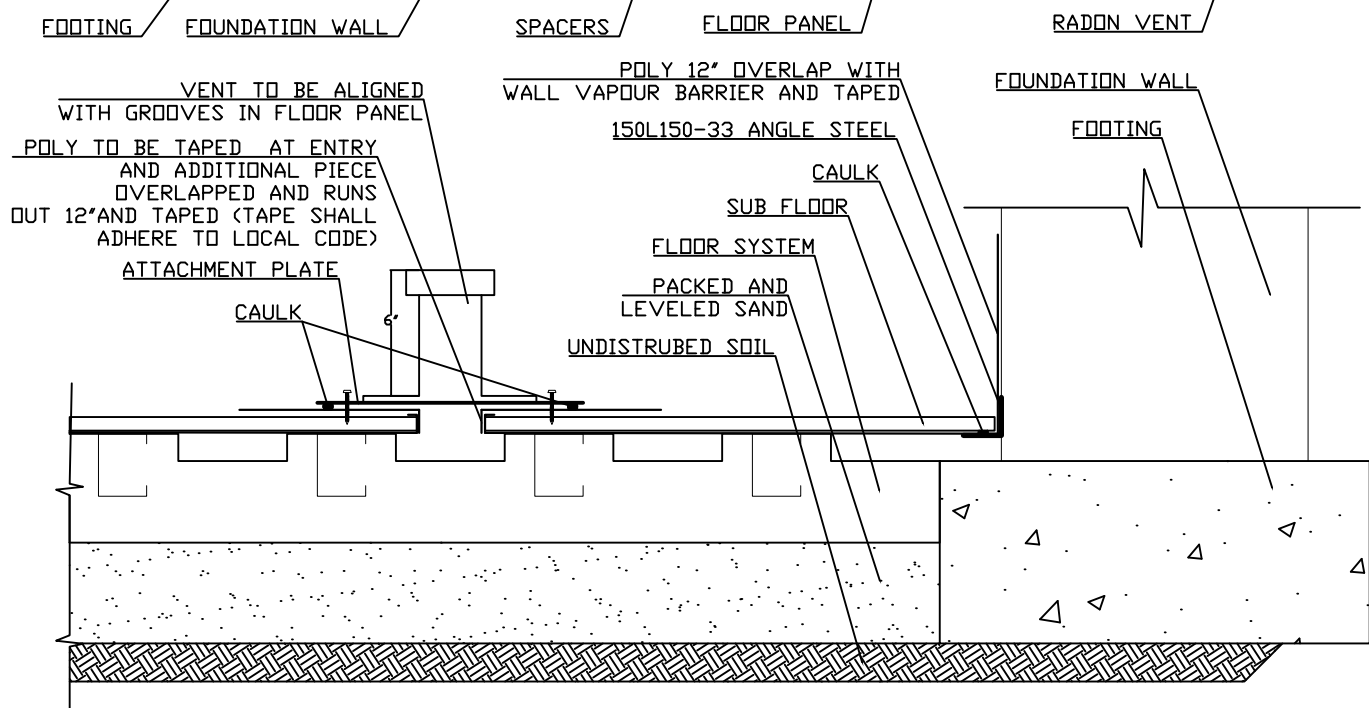
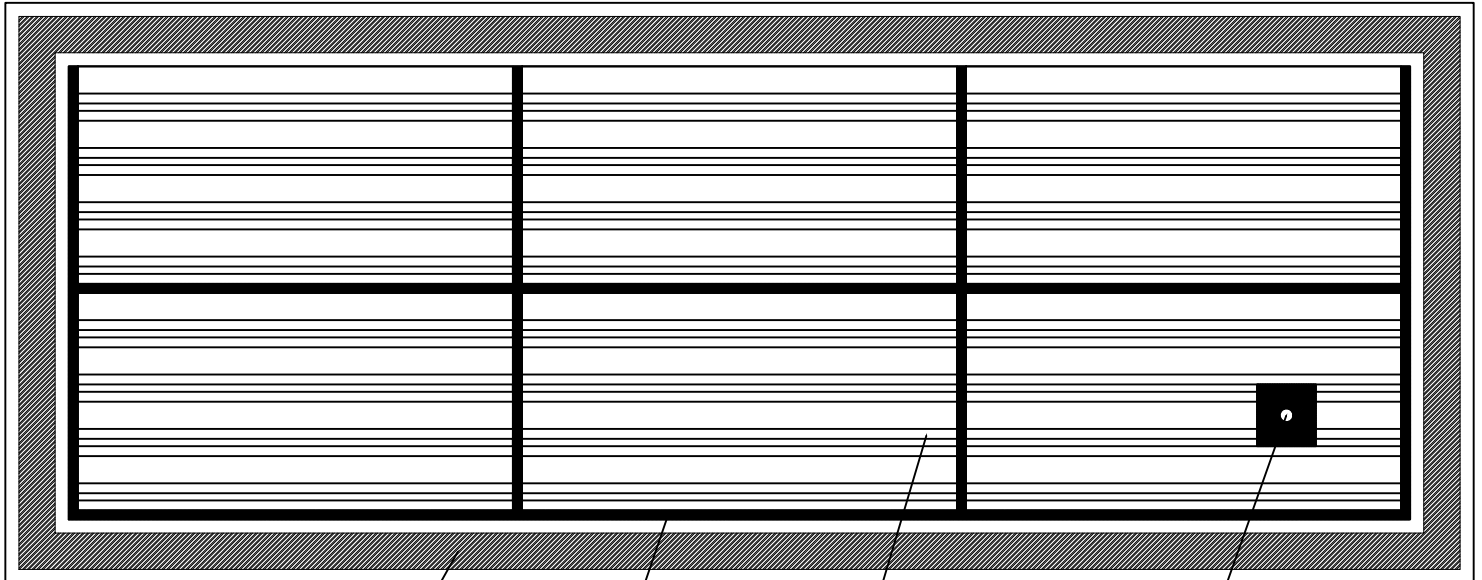

S I Construction Systems Ltd
4638 - 91st Avenue NW
Edmonton, AB T6B 2L1
Ph: (780)-450-2584
www.sie-sys.com

DRAWING TITLE:
Radon Detail Floor System

DRAWN BY:
LEL
DATE:
2020-04-03

SCALE:
NTS
DETAIL NO:
4

This Structural Insulation Construction System detail is to assist in creation of your system and for use with.
ENGINEERED FOR S I CONSTRUCTION SYSTEMS LTD PANEL SYSTEMS ONLY
ALL OTHER CONSTRUCTION TO CONFORM TO ABC-2014 AND NBC 2012